

JOIN THE ROOF TIE DOWN REVOLUTION



BUILDING PRODUCTS

**HIGH PERFORMANCE
HIGH CAPACITY
ROOF TRUSS CONNECTIONS**

Burmon Building Products

USA & CANADA

Toll Free 1-800-369-6380

www.burmon.com



HURRICANE ANCHOR for DOUBLE TOP PLATE

U.S. Patent Application No. 14/908.536A Canadian Patent Application No. 2956685

"The best new product that has entered the building industry in the last 10 years"

- Nick Bruin, Multiple Master Builder Award Winner

Burmon combines its patented Hurricane Anchors with Impact Driver technology to deliver the most efficient and effective roof truss/rafter tie down system available, saving time and money.

USING BURMON HURRICANE ANCHORS GIVES YOU THE ADVANTAGE:

- ✓ Code Compliant - 2012 International Residential Code (IRC) & 2012 International Building Code
- ✓ Designed and engineered to resist 96% of all global high wind events
- ✓ Anchors can be fixed to top plate whilst on the ground first, making it safer and faster when working at heights
- ✓ No toe nailing required
- ✓ No hand nailing required
- ✓ Stronger, faster connection
- ✓ Anchors hold trusses in position making bracing easier and safer

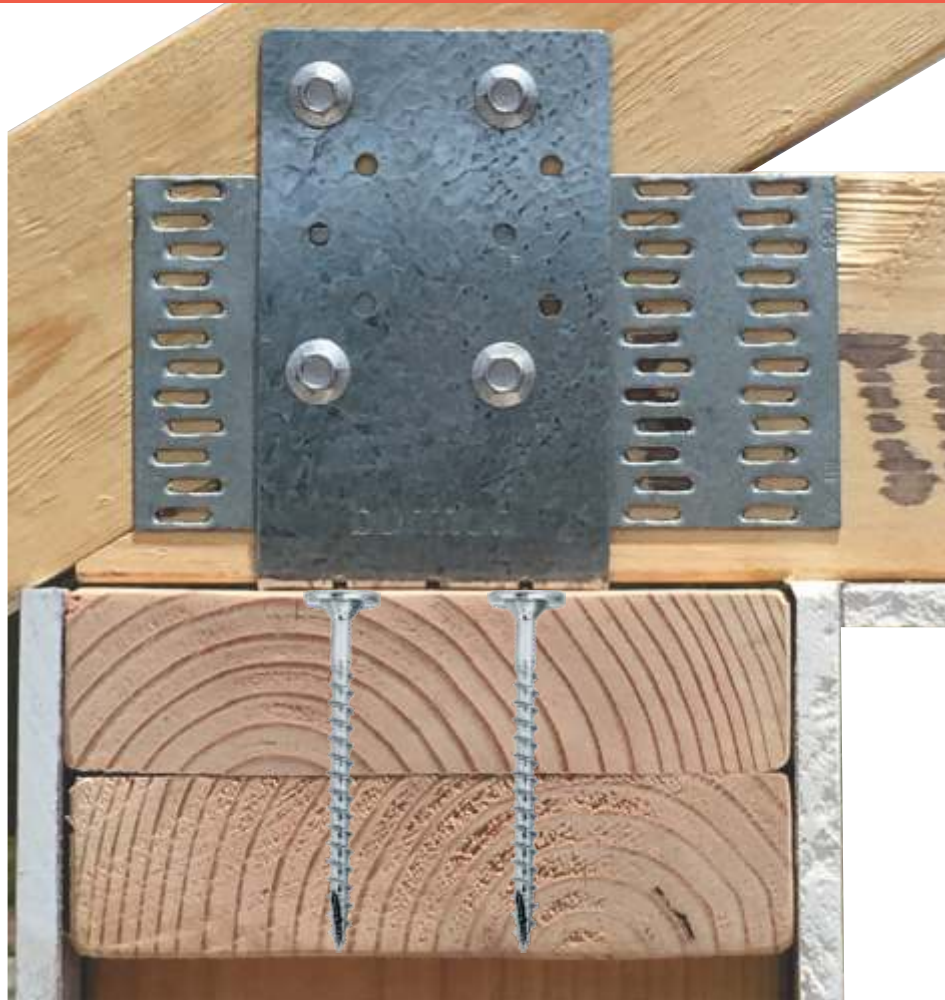

EASY TO INSTALL

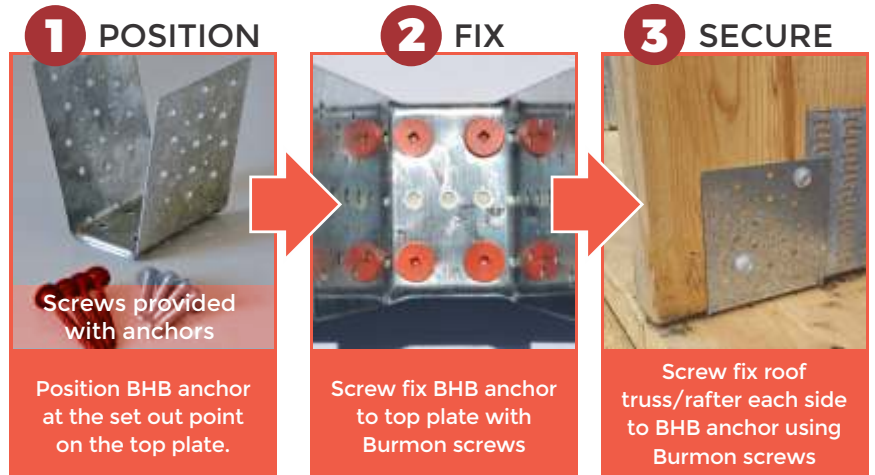



HURRICANE ANCHOR

U.S. Patent Application No. 14/908.536A Canadian Patent Application No. 2956685

SPECIFICATION

STEEL

Gauge **18**
Corrosion Finish **G90**

SCREWS

Burmon screws comply to 1000 hours Salt Spray Testing



BURMON STOCK CODE

BHBDP

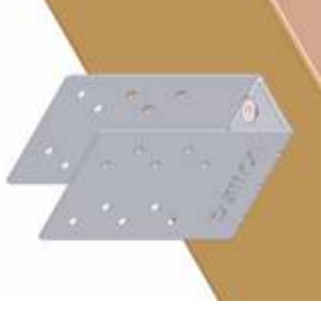
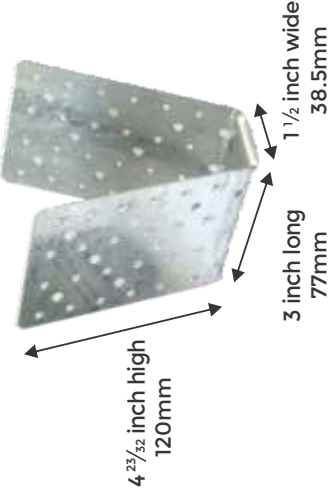

1. Allowable loads have been increased 60% for wind and seismic loads, no further increase shall be permitted.
2. Minimum quantity of fasteners to be installed. Product has additional screw holes not needed to meet published allowable load of product.
3. To view code report, please visit our website www.burmon.com/code-reports or visit the code evaluation agency's website.

burmon		FASTENER SCHEDULE			Installation type	DF/SP Allowable Load (lbs) ¹			S-P-F Allowable Load (lbs) ¹			Corrosion Finish
		Truss/Rafter	Double Plate			Uplift 160%	Lateral F1 160%	Lateral F2 160%	Uplift 160%	Lateral F1 160%	Lateral F2 160%	
BHBDP	BHB	18	6 3 each side	BHH39	4	BSD65	1009	815	1381	787	635	G90
BHBDP	BHB	18	8 4 each side	BHH39	6	BSD65	2657	1222	2072	1181	953	G90
					DOUBLE ANCHOR	5314	3028	4144	2362	1906		



HURRICANE ANCHOR for SINGLE TOP PLATE

U.S. Patent Application No. 14/908.536A Canadian Patent Application No. 2956685

The highest capacity single top plate connector in the world!

Burmon combines its patented Hurricane Anchors with Impact Driver technology to deliver the most efficient and effective roof truss/rafter tie down system available, saving time and money.

USING BURMON HURRICANE ANCHORS GIVES YOU THE ADVANTAGE:

- ✓ Code Compliant - 2012 International Residential Code (IRC) & 2012 International Building Code
- ✓ Designed and engineered to resist 96% of all global high wind events
- ✓ Anchors can be fixed to top plate whilst on the ground first, making it safer and faster when working at heights
- ✓ No toe nailing required
- ✓ No hand nailing required
- ✓ Stronger, faster connection
- ✓ Anchors hold trusses in position making bracing easier and safer

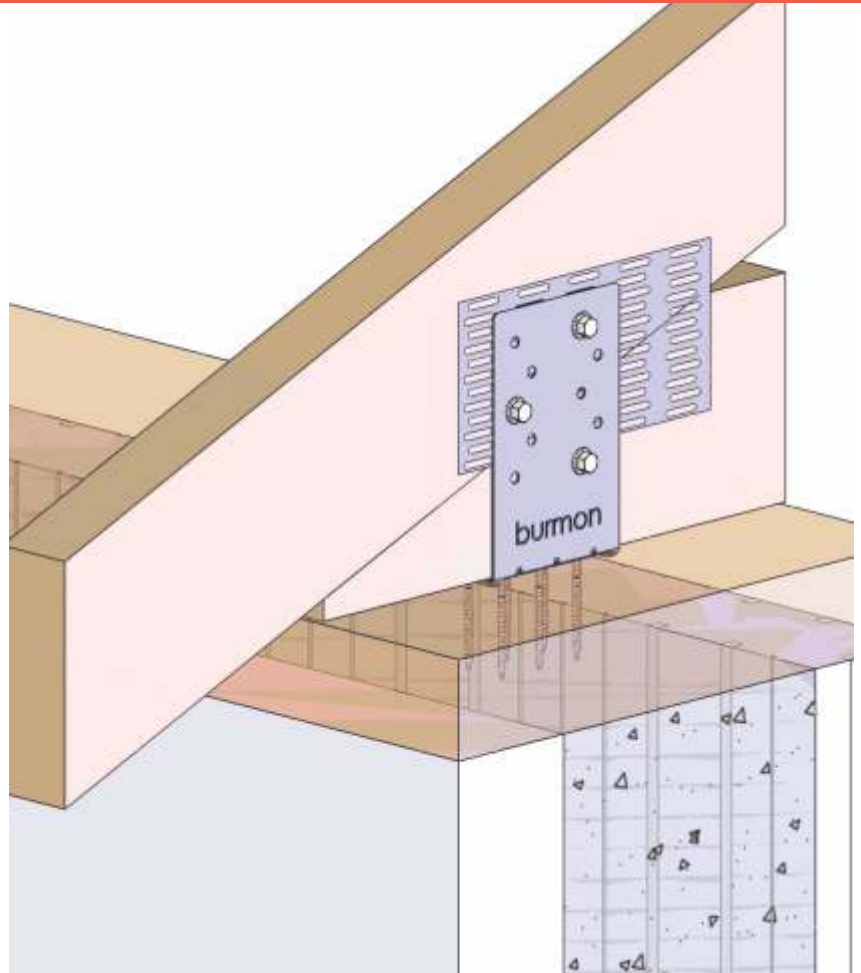

EASY TO INSTALL

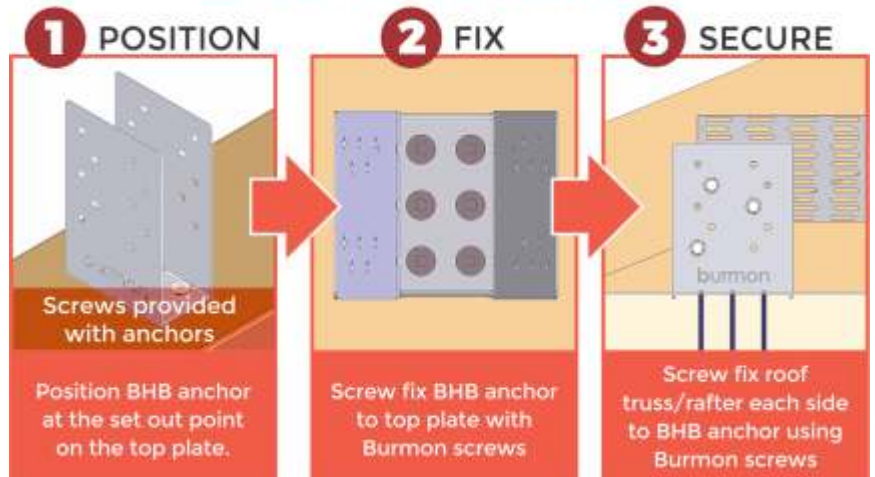



HURRICANE ANCHOR for SINGLE TOP PLATE

U.S. Patent Application No. 14/908.536A Canadian Patent Application No. 2956685

SPECIFICATION

STEEL

Gauge 18
Corrosion Finish G90

SCREWS

Burmon screws comply to 1000 hours Salt Spray Testing



4³²/₃₂ inch high
120mm

3 inch long
77mm

BURMON STOCK CODE

BHBSP

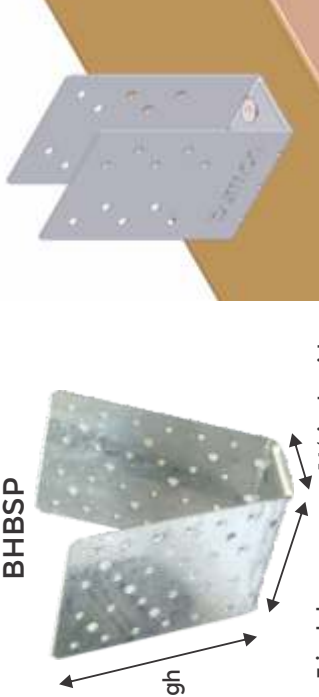

1. Allowable loads have been increased 60% for wind and seismic loads, no further increase shall be permitted.
2. Minimum quantity of fasteners to be installed. Product has additional screw holes not needed to meet published allowable load of product.
3. To view code report, please visit our website www.burmon.com/code-reports or visit the code evaluation agency's website.

Please note: these are single plate numbers

burmon	FASTENER SCHEDULE		Installation type	DF/SP Allowable Load (lbs)'			S-P-F Allowable Load (lbs)'			Corrosion Finish				
	Truss/Rafter	Single Plate		Uplift	Lateral F1	Lateral F2	Uplift	Lateral F1	Lateral F2					
BHBSP	BHB	18	6	BHH39	4	BSD39	SINGLE ANCHOR	1340	763	616	1044	595	480	G90
			3 each side											
BHBSP	BHB	18	8	BHH39	6	BSD39	SINGLE ANCHOR	2010	1145	924	1567	893	720	G90
			4 each side											



HURRICANE ANCHOR

for RAFTER/TRUSS CONNECTION to ICF BLOCK & CMU BLOCK WALL

Designed and engineered specifically for concrete construction

USING BURMON ICF HURRICANE ANCHOR GIVES YOU THE ADVANTAGE:



- ✓ Code Compliant - 2012 International Residential Code (IRC) & 2012 International Building Code.
- ✓ Designed to resist 98% of all global wind events
- ✓ No hand nailing required
- ✓ Trusses screw fixed through nail plate
- ✓ Hurricane Anchor fixed into place over ICF and CMU Wall
- ✓ Half the cost of other connectors while delivering extremely high load capacities
- ✓ Significant cost savings to the total house build
- ✓ Stronger, faster connection
- ✓ Anchors hold trusses in position making bracing easier and safer

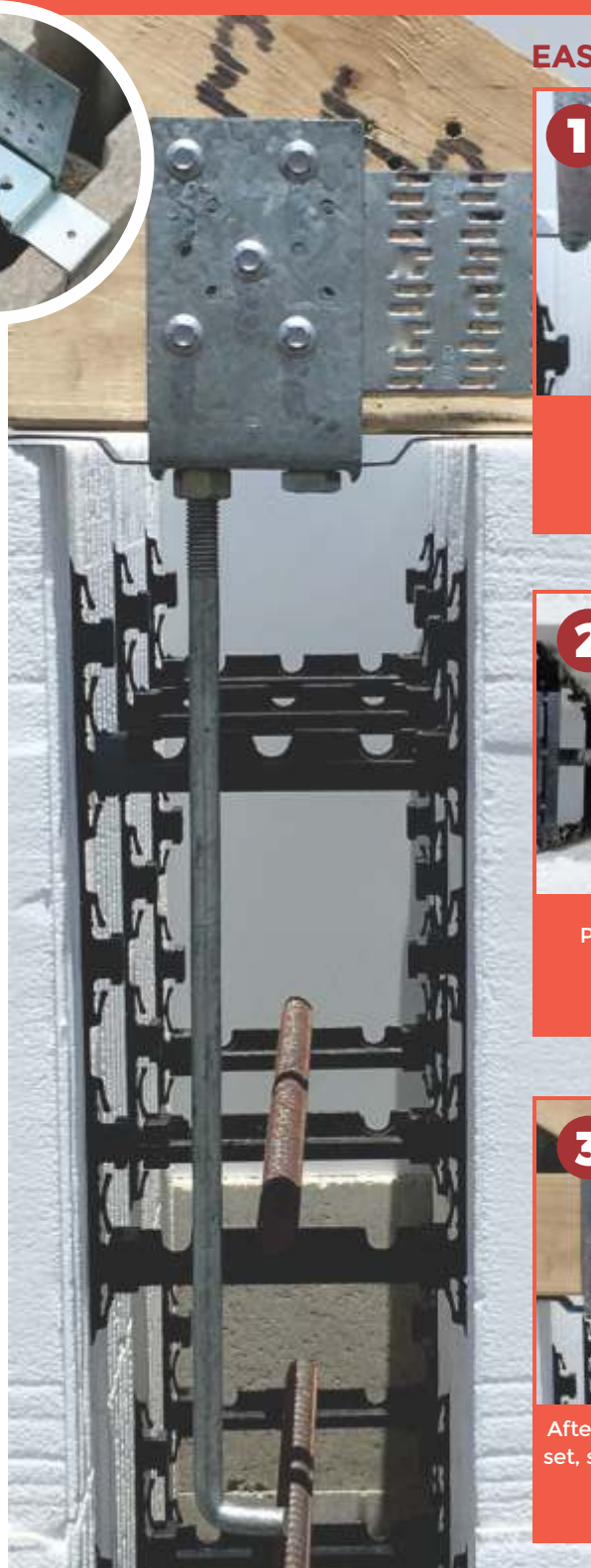

EASY TO INSTALL

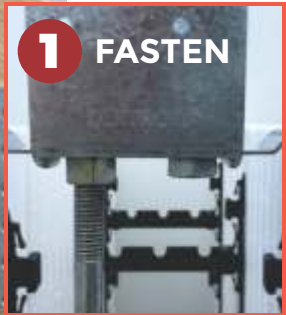

1 FASTEN

Screw L-Bolt to BHBCON and tighten



2 POSITION

Position BHBCON at truss/rafter mark



3 FIX

After concrete pour and set, screw truss/rafter to BHBCON



HURRICANE ANCHOR

for RAFTER/TRUSS CONNECTION to ICF BLOCK & CMU BLOCK WALL

SPECIFICATION

BURMON STOCK CODES

BHBCONICF
BHBCONCMU

STEEL

Gauge 18
Corrosion Finish C90
Bracket Mild steel
Threaded washer Alloy Steel, HDG
L-Bolt

SCREWS

Burmon screws
comply to 1000 hours
Salt Spray Testing

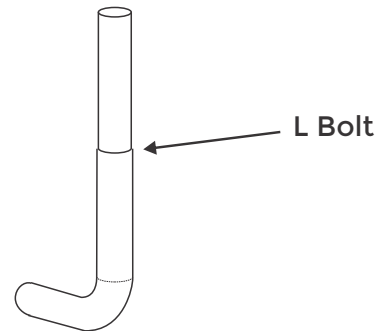
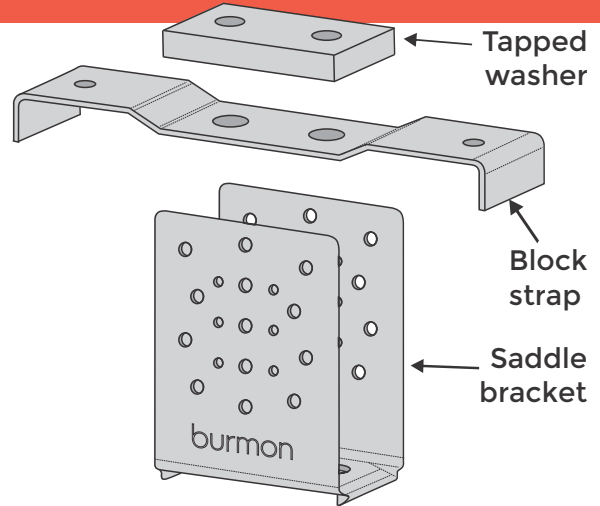

1. Allowable loads have been increased 60% for wind and seismic loads, no further increase shall be permitted.
2. Allowable loads are based on anchorage to masonry/uncracked concrete.
3. Minimum specified masonry or concrete compressive strength f'_m 1500 psi and f'_c is 2500 at 28 days respectively.
4. Minimum quantity of fasteners to be installed. Product has additional screw holes not needed to meet published allowable load of product.
5. Screw L-Bolt to threaded washer until bolt sits flush with threaded washer and tighten nut.
6. To view code report, please visit our website www.burmon.com/code-reports or visit the code evaluation agency's website.

burmon			L-BOLT (embedded into concrete)	FASTENER SCHEDULE		SP/DF Allowable Load				Corrosion Finish
Burmon Stock No.	Ref No.	Steel Gauge		Min Qty	Type Burmon Screws	MASONRY	CONCRETE	MASONRY	CONCRETE	
BHBCON	BHBCON	18	15 3/4 inches Alloy Steel, HDG	10 (5 each side)	BHH	3105	3105	1552	1552	L-Bolt: HDG Anchor: G90

The Burmon Hurricane Bracket complies with (IBC), (IRC) & (EC-002)